

Uplink®

Uplink® Android App Overview v3.2

2023 Uplink Security Inc. All rights reserved.

LOGIN

Get the Uplink app from the App Store. Once you've downloaded and installed the app, use the credentials from the quick install manual to log in to your account.

Uplink[®]

Welcome!

Please Sign In to continue

Username

Password

Forgot your username or password?

Sign In

By signing In you agree with our [Privacy Policy](#).
All rights reserved by ©2022 Uplink

Upon initial login you will be prompted to enter a password reset email.

Password recovery email

Enter email where in case of forgotten password, you will receive the new one. This information will be used only for password recovery.

Email

Save

FIRST LOOK

Upon first start, the only active functionality will be the events log.

To access the account menu, click here.

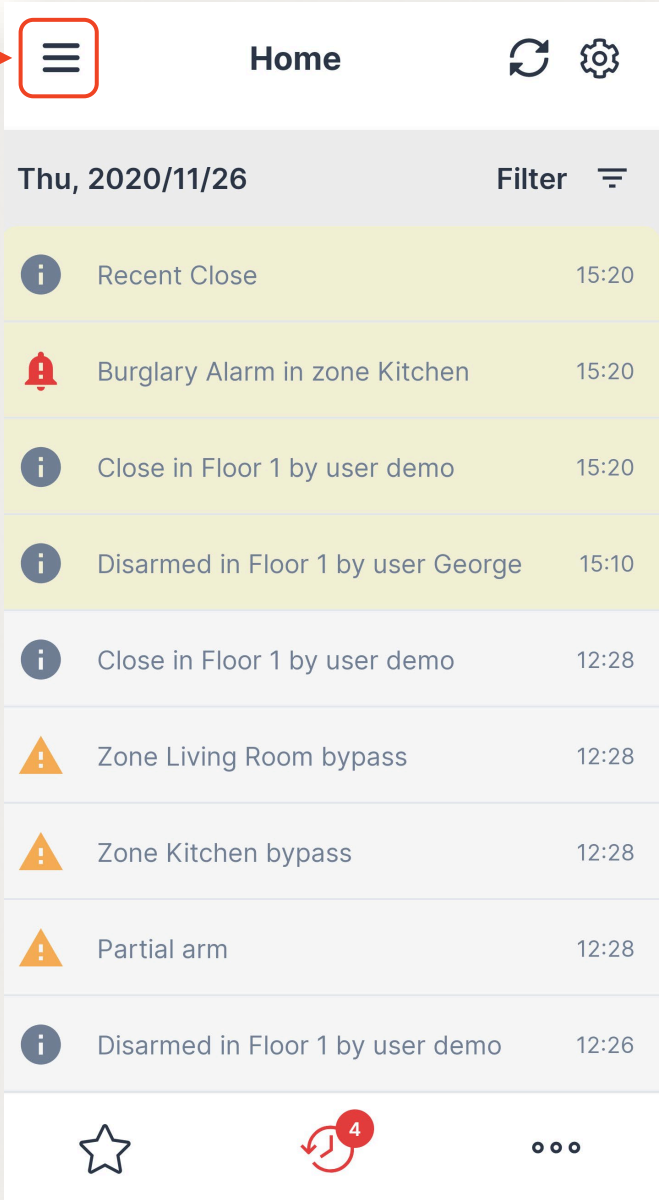

Go to settings to configure the App.

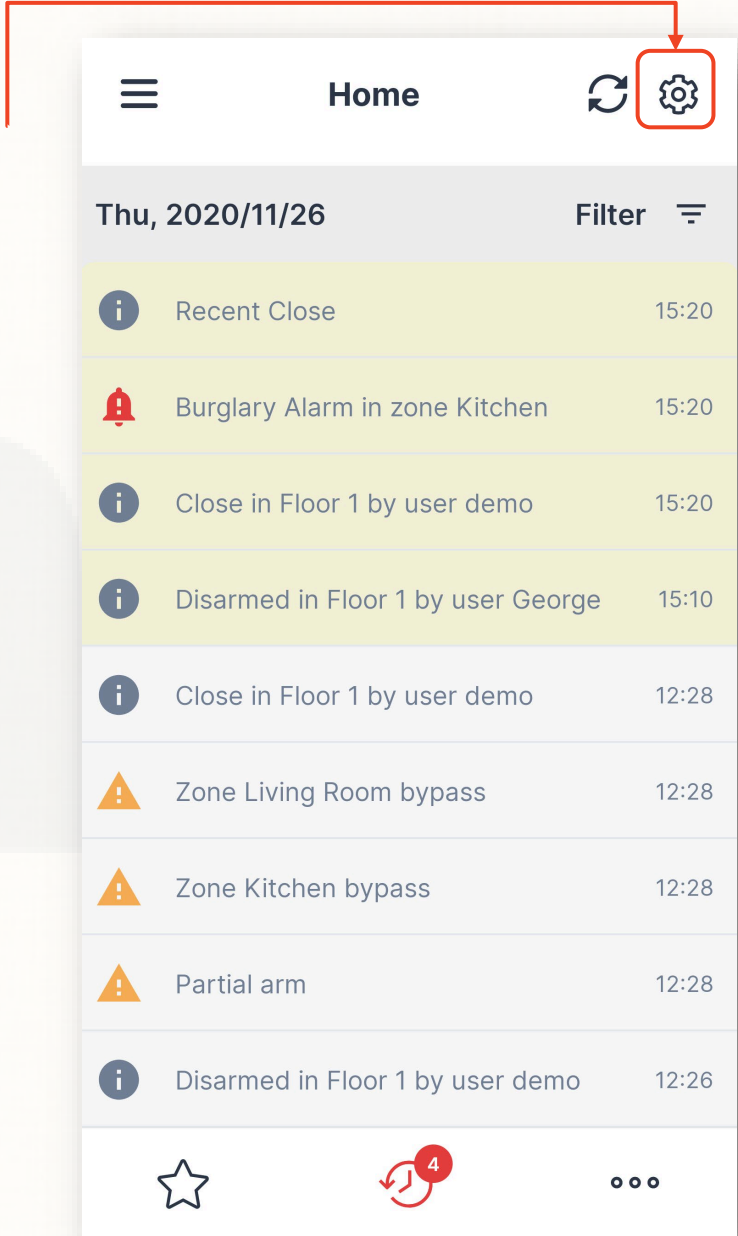

USERNAME AND PASSWORD

Go to the “My Account” icon if you want to change your username and password.

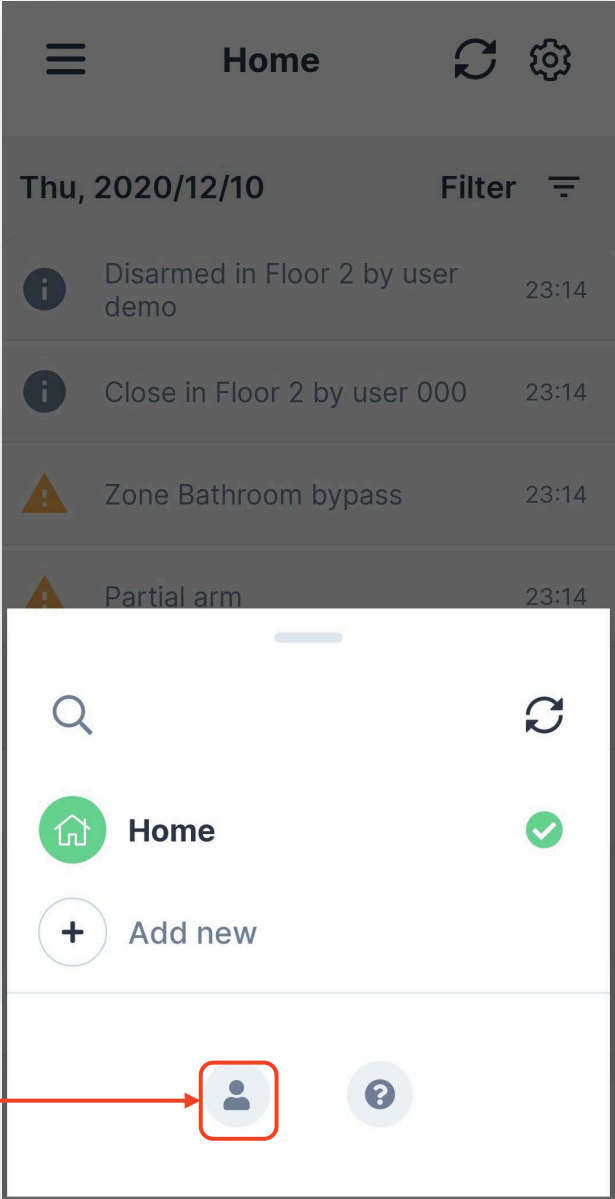
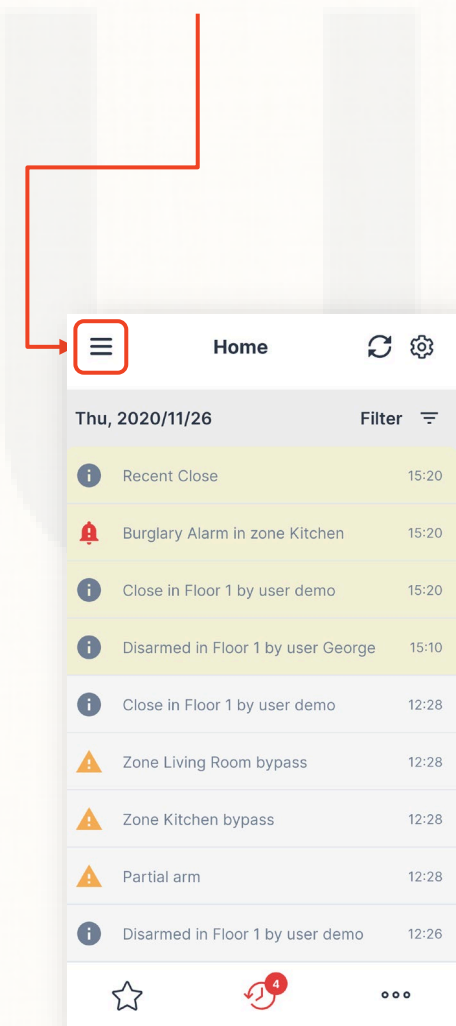

Press “Edit” in the User settings menu.

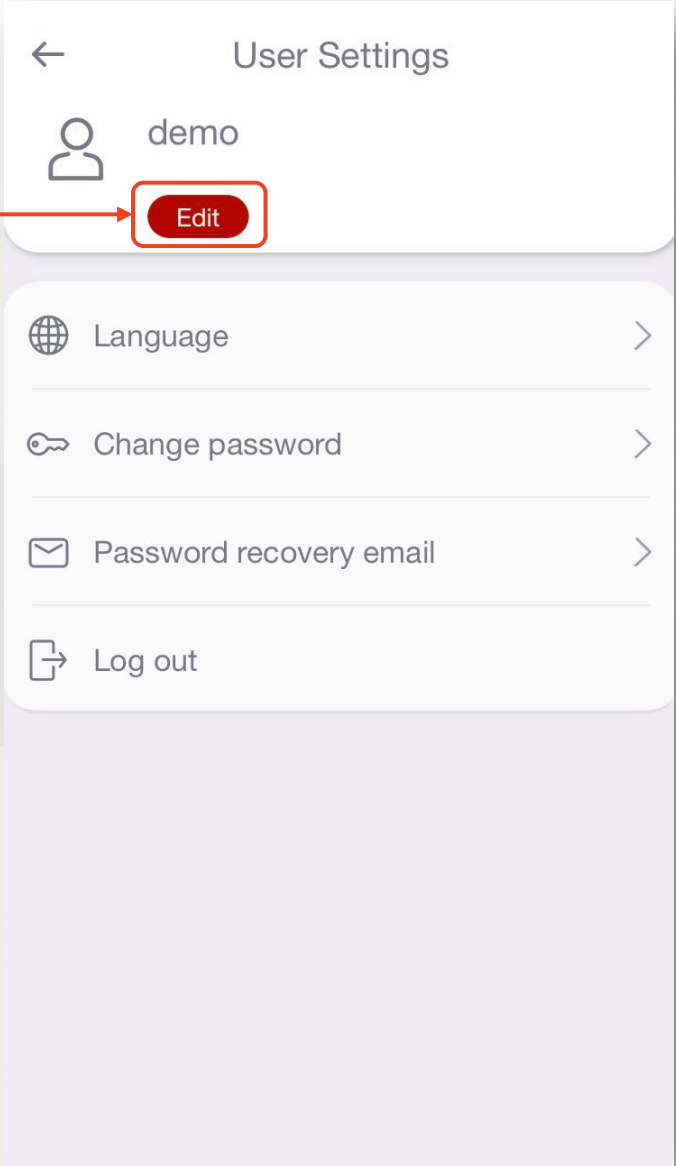

USERNAME AND PASSWORD

←

Edit user name

Full name

demo

Login name

demo

Save

Fill in the desired fields and press "Save" when done.

←

Change password

Old password

New password

Confirm password

Save

LANGUAGE

Go to the “User Settings” menu and select “Language” if you want to change your preferred language.

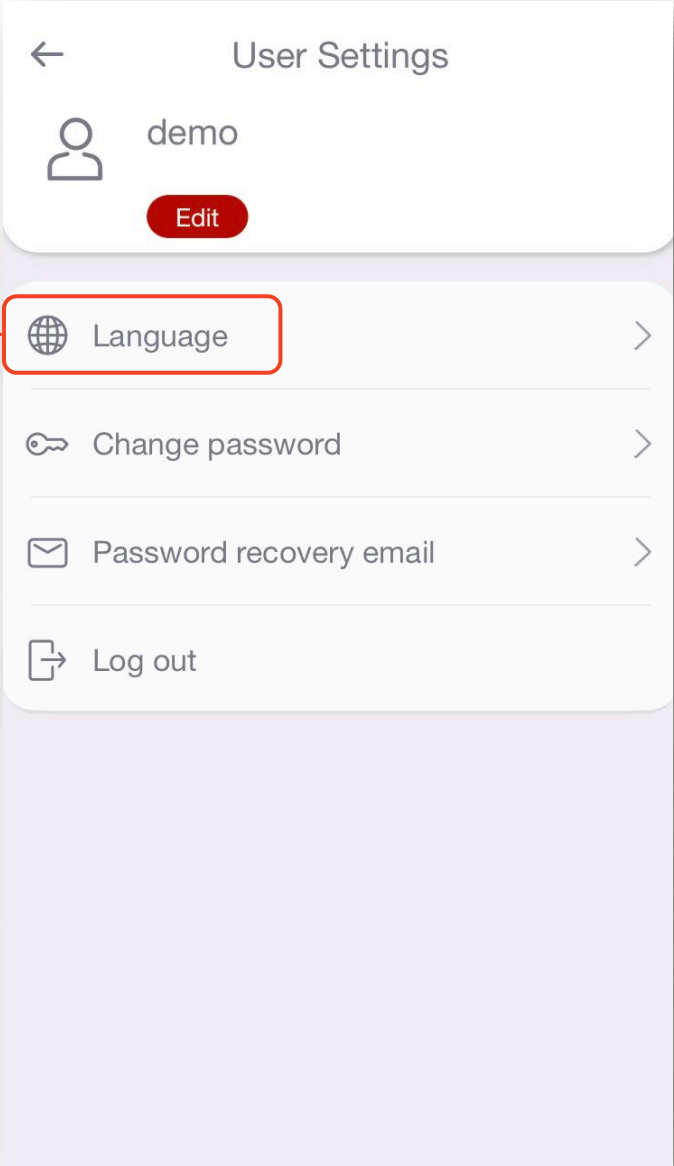
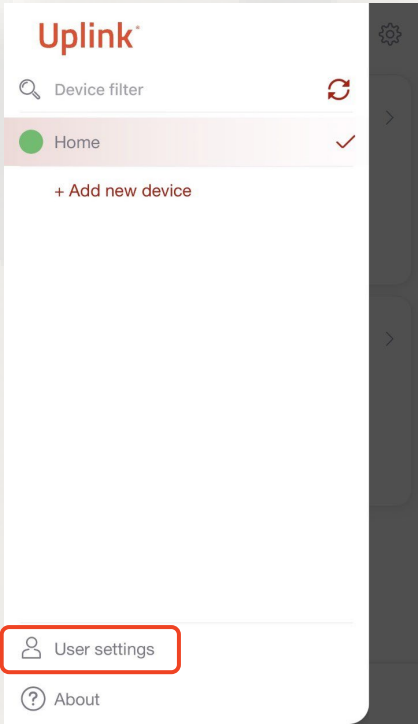

Select your language of choice and press “Save”.

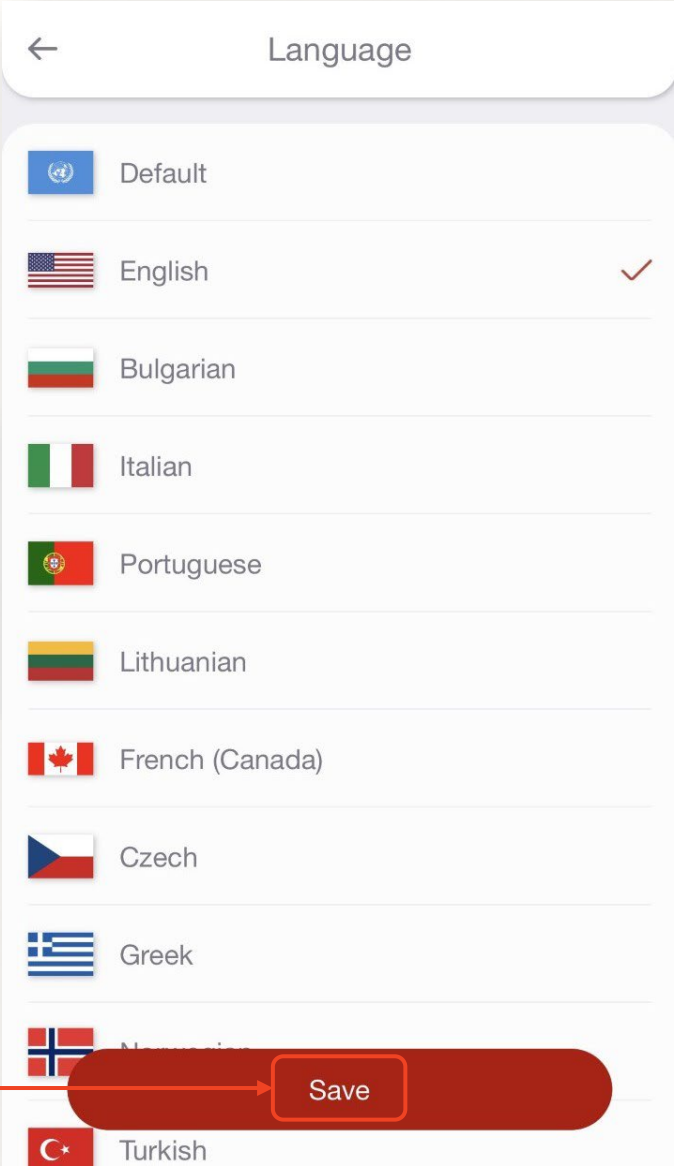

NOTIFICATIONS

Go to “Notifications” and choose how you would like to receive different events on your smartphone.

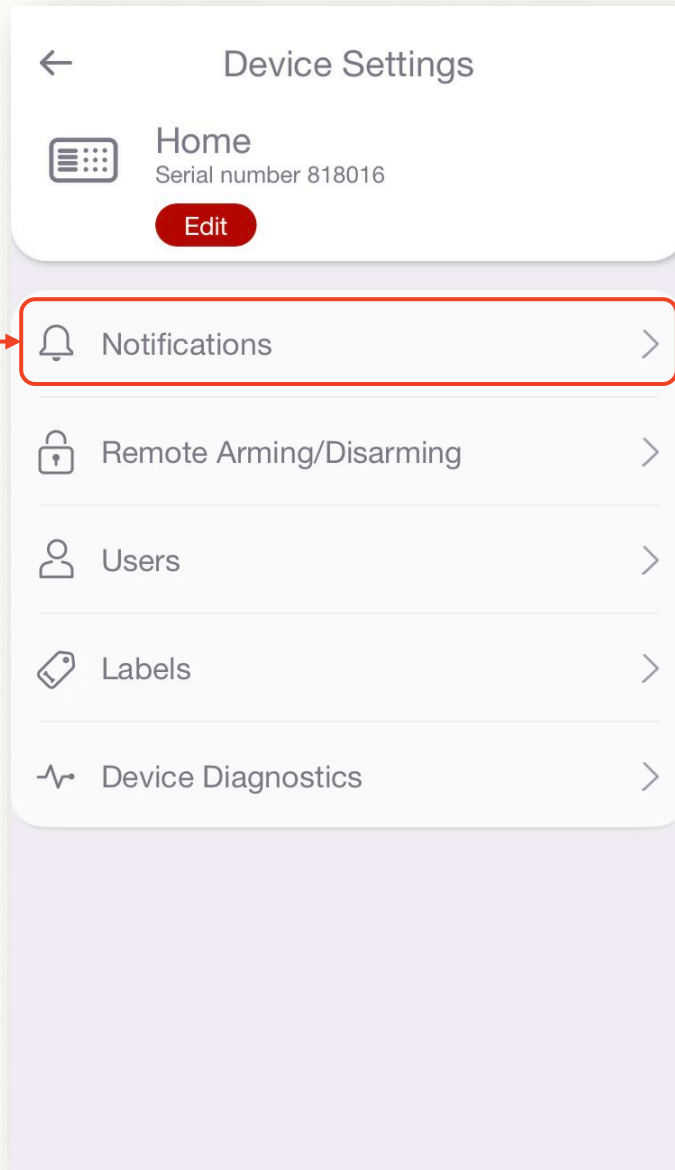

Select the “+ Add” button for your preferred way of notification.

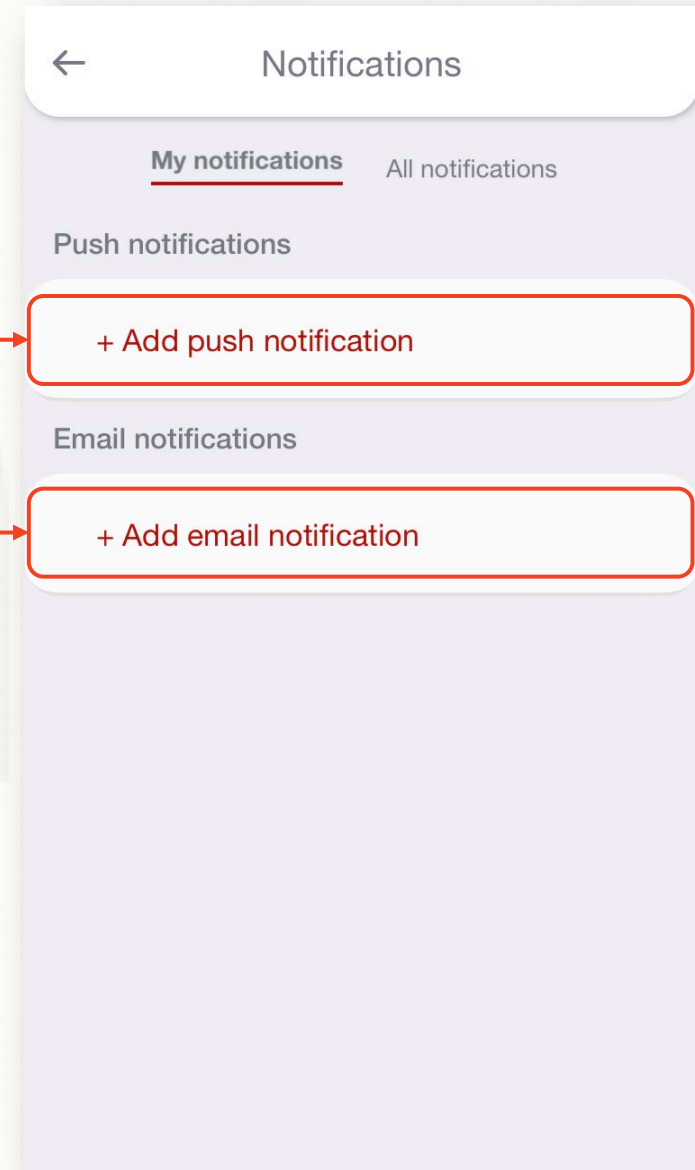

NOTIFICATIONS

Select type of events to be reported for each notification channel.

Can be used when your phone is in “vibrate” mode and you want to be sure that you won’t miss something.

Push notification

13e21cfd-cd8f-4fc8-bed7-12c9f12e60b3

Alarms

Default ringtone (Bongo), Vibrate

Troubles

Default ringtone (Bongo), Vibrate

Information

Default ringtone (Bongo), Vibrate

Repeat alarm type notification infinitely

Save

Your notification channels will be displayed as a list.

To make changes, select the notification you’d like to edit or remove. Thus, returning to the previous screen.

Notifications

My notifications

All notifications

Push notifications

Created by test_account

Email notifications

info@uplink.com

+ Add email notification

2023 Uplink Security Inc. All rights reserved.

HOW TO ENABLE REMOTE ARMING/DISARMING

To enable this functionality, additional wiring and configuration of the alarm panel must be done by your installer.

Go to "Remote Arming/Disarming" to setup this functionality.

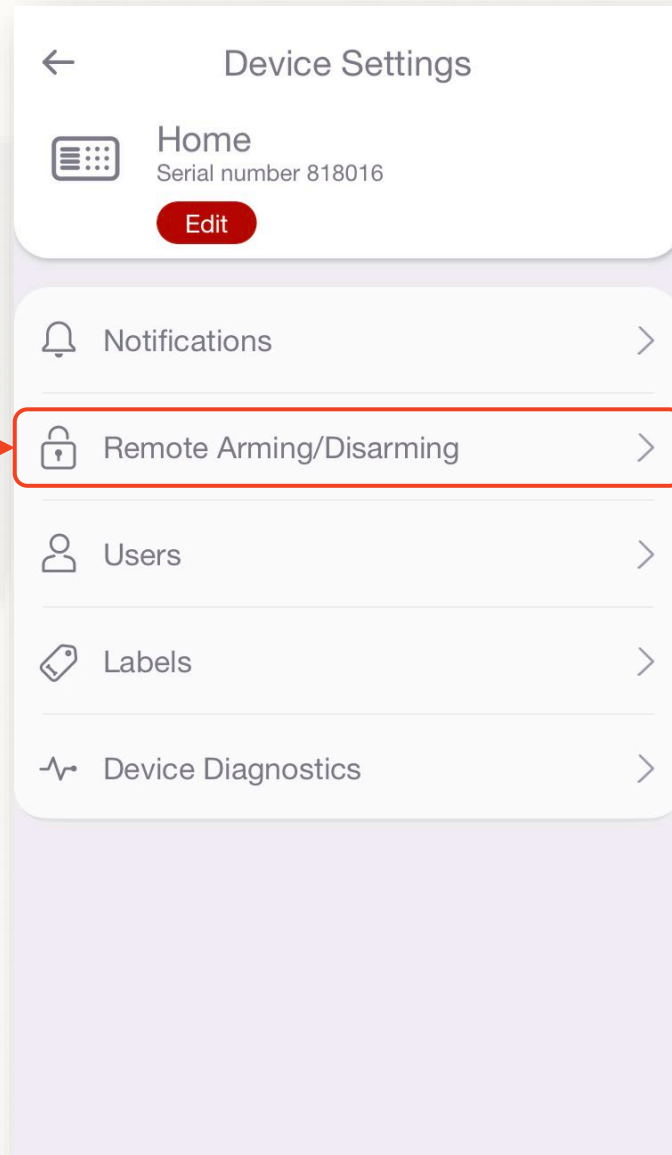

Slide to enable the Remote arming/disarming.

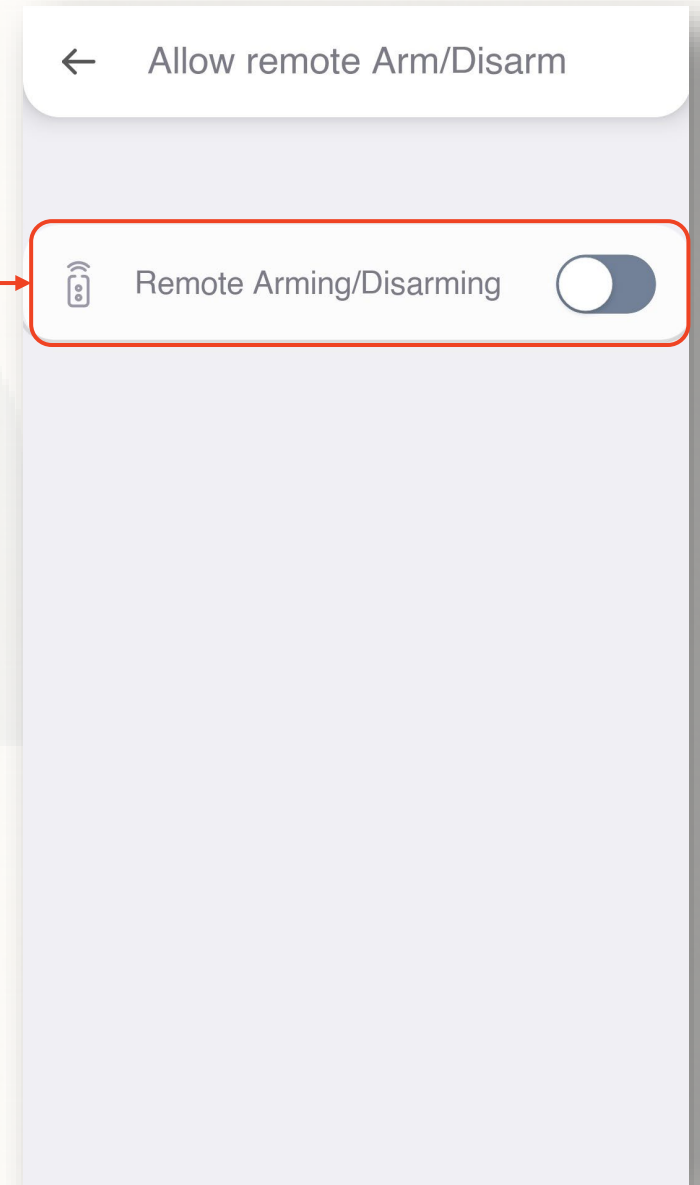

REMOTE ARMING/DISARMING (KEYBUS WIRING – DSC PANELS)

To enable this functionality, additional wiring and configuration of the alarm panel must be done by your installer.

Confirm to enable the functionality.

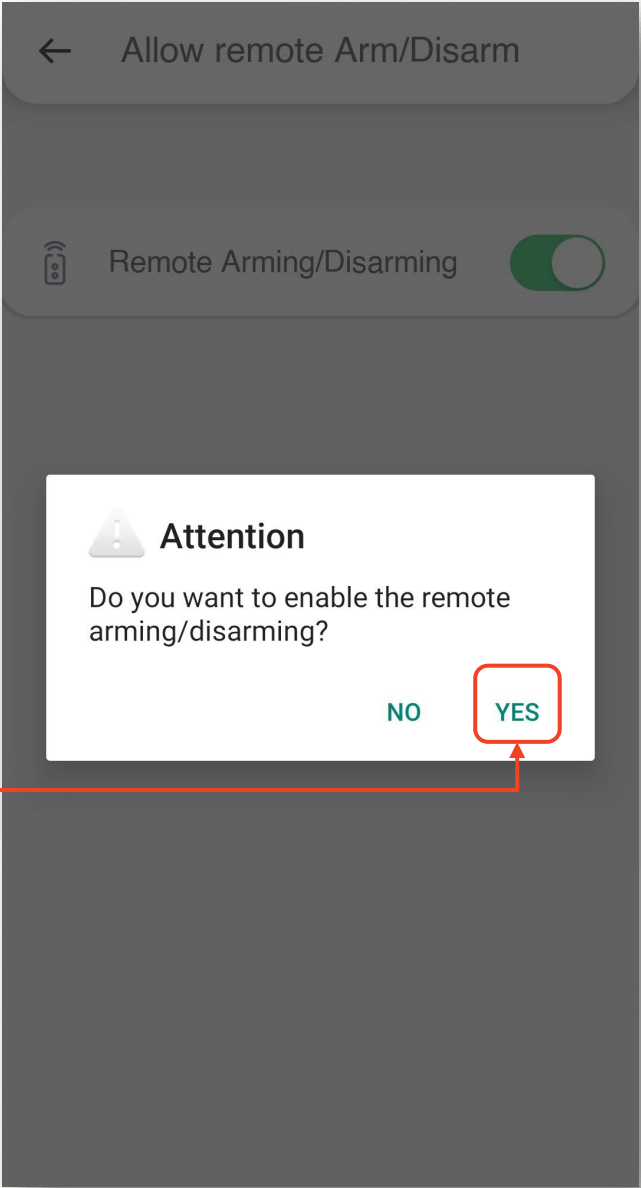

After confirmation, the Remote Arming/Disarming feature will be available at the homepage.

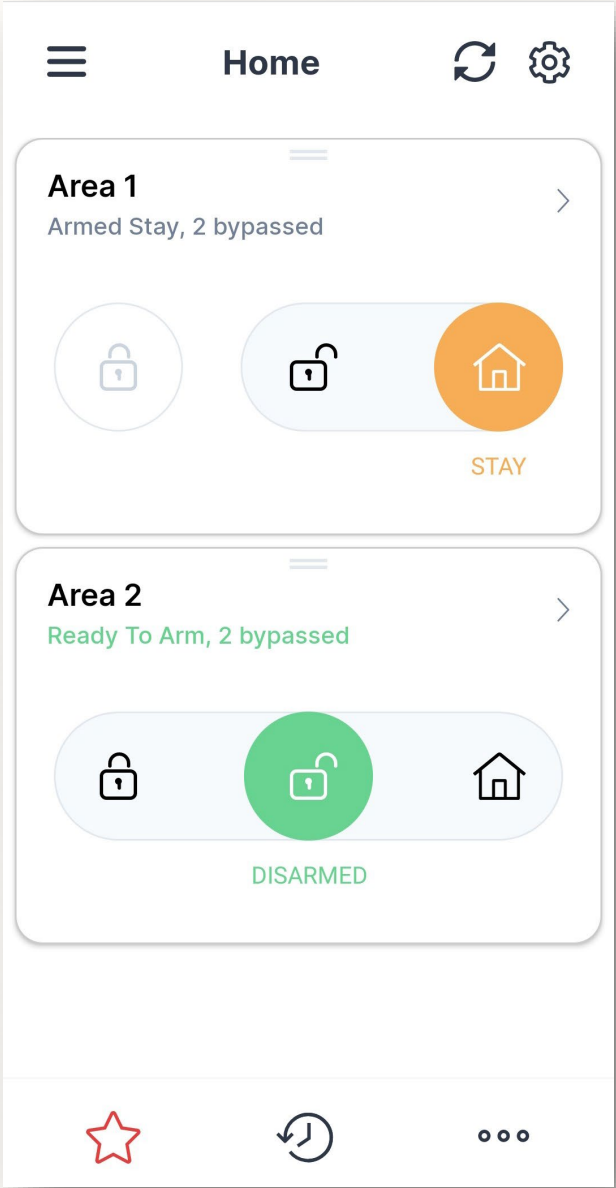

REMOTE ARMING/DISARMING (KEYBUS WIRING – HONEYWELL PANELS)

To enable this functionality, additional wiring and configuration of the alarm panel must be done by your installer.

Confirm to enable the functionality.

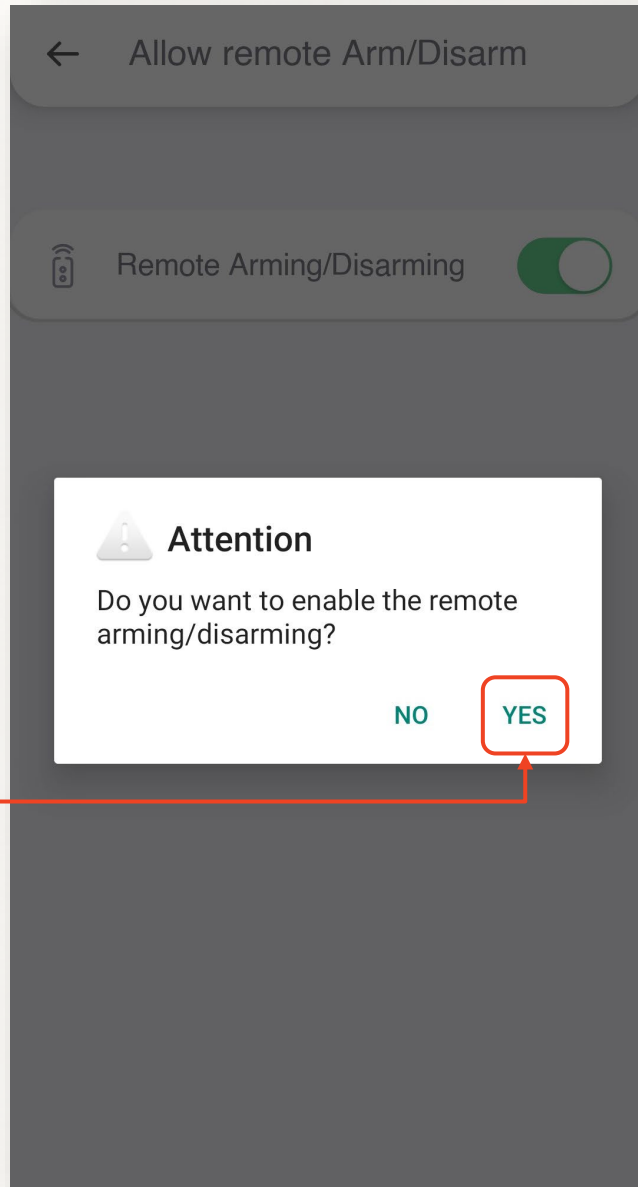

In order to synchronize the settings from the panel ask your alarm installer to enter and exit programming mode from the keypad of your alarm panel.

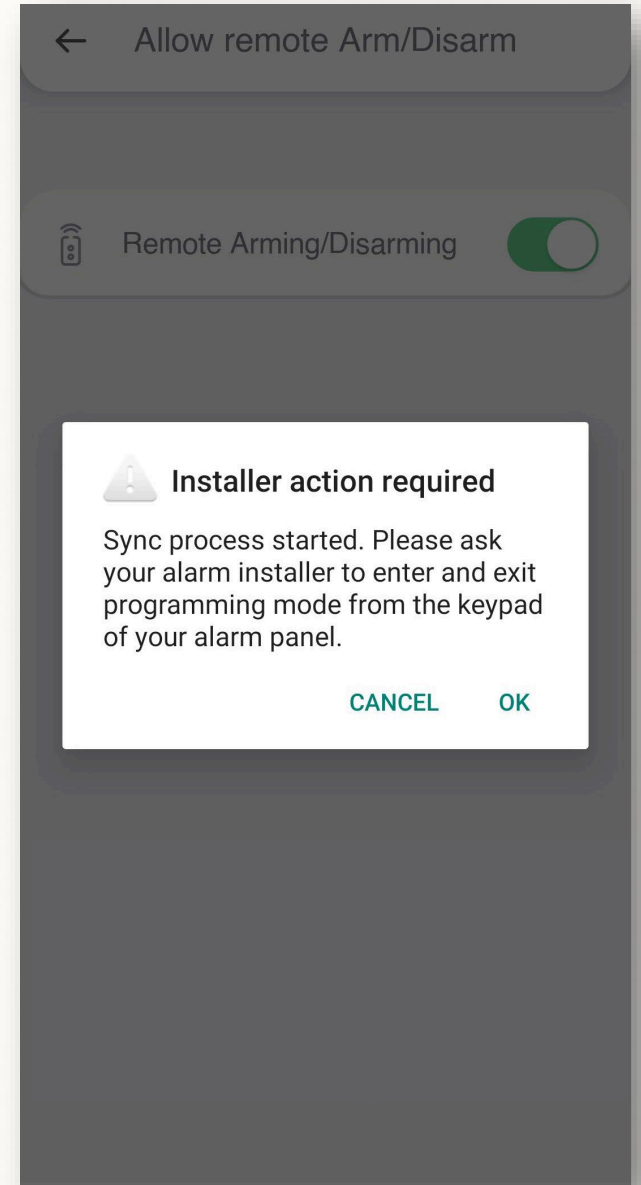

REMOTE ARMING/DISARMING (KEYBUS WIRING – HONEYWELL PANELS)

To enable this functionality, additional wiring and configuration of the alarm panel must be done by your installer.

The installer should enter and exit programming mode within the timeframe specified in the mobile app.

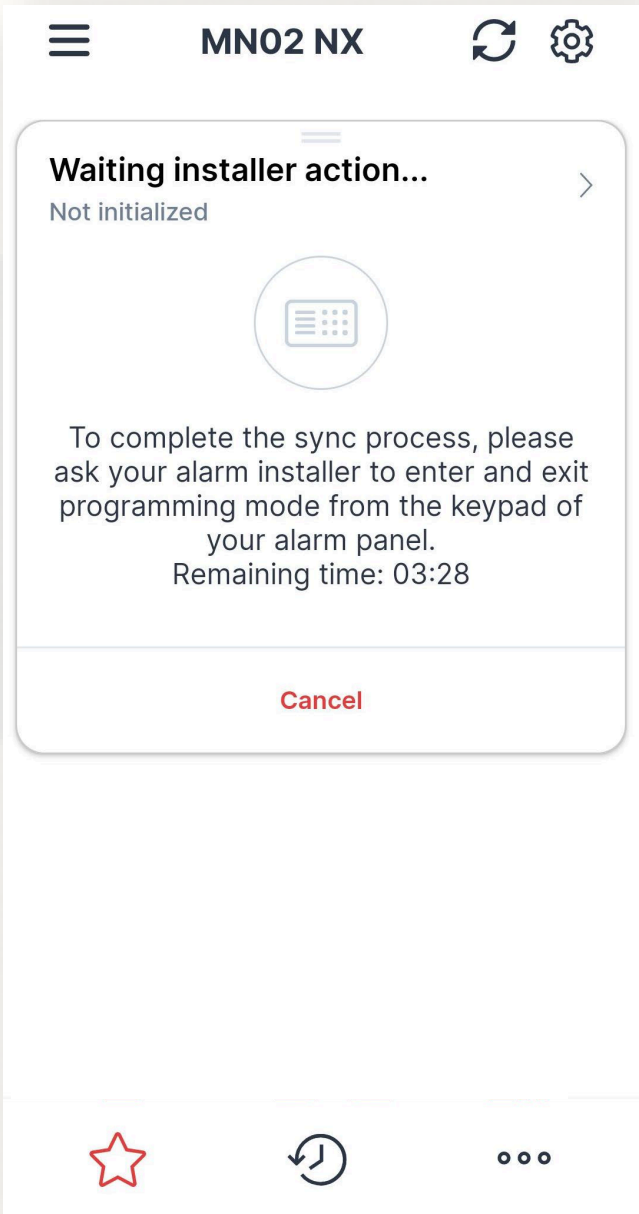

Wait for the app to synchronize with your alarm panel.
Do not operate the keypad during the sync process.

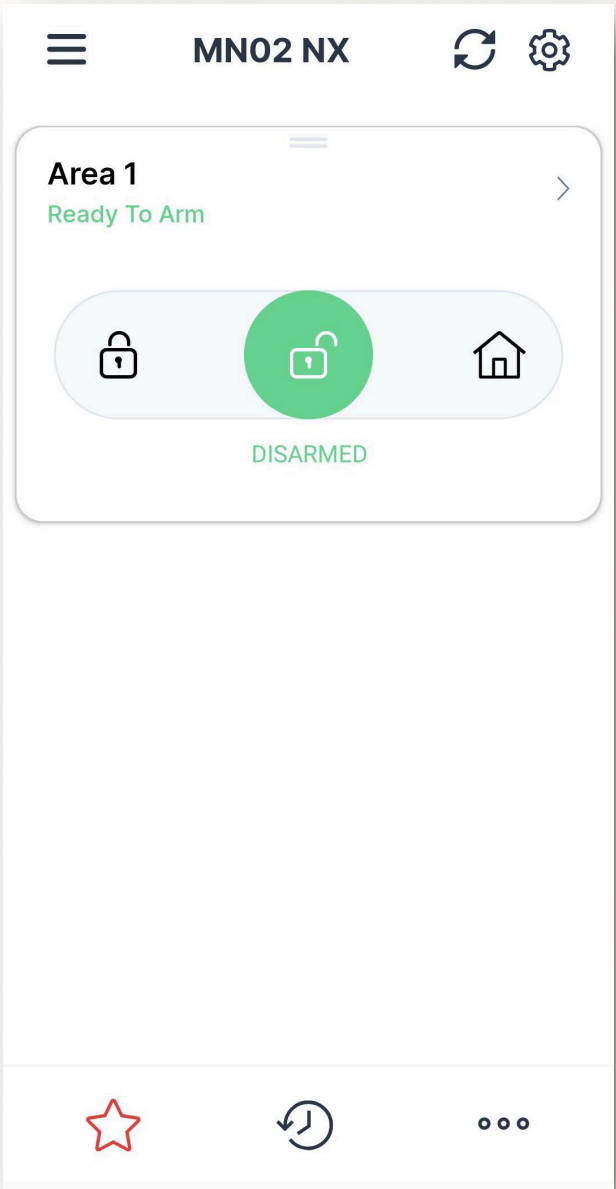
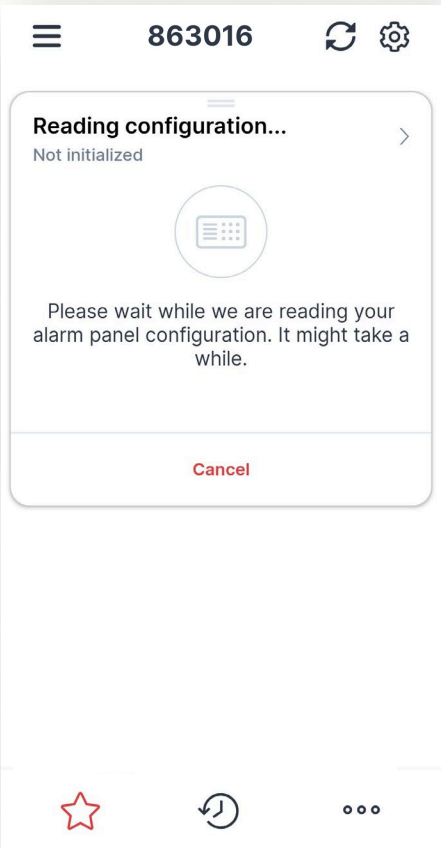

REMOTE ARMING/DISARMING (SYNCH WITH PANEL)

To enable this functionality, additional wiring and configuration of the alarm panel must be completed by the installer.

If panel programming is changed after the initial synchronization you need to select "Sync with Panel" and follow the instructions in the app.

DO NOT operate the keypad during the sync process.

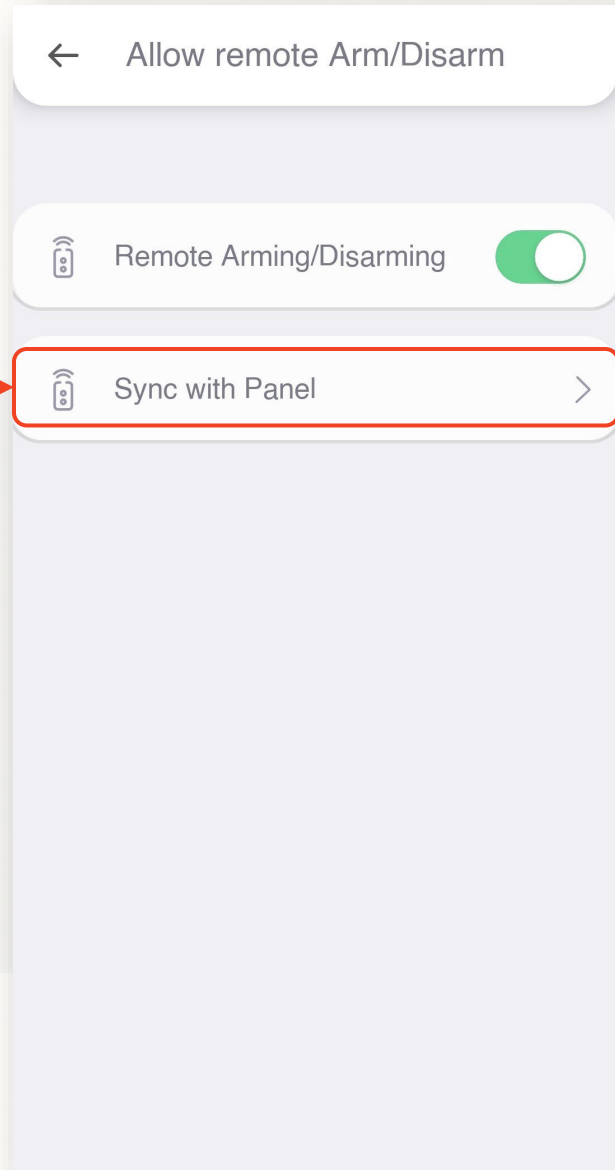

REMOTE ARMING/DISARMING (KEYSWITCH WIRING)

To enable this functionality, additional wiring and configuration of the alarm panel must be completed by the installer.

Upon first activation, you will be asked to set the PIN for the remote ARM/DISARM. Enter and confirm your 4-digit PIN then press "Continue"

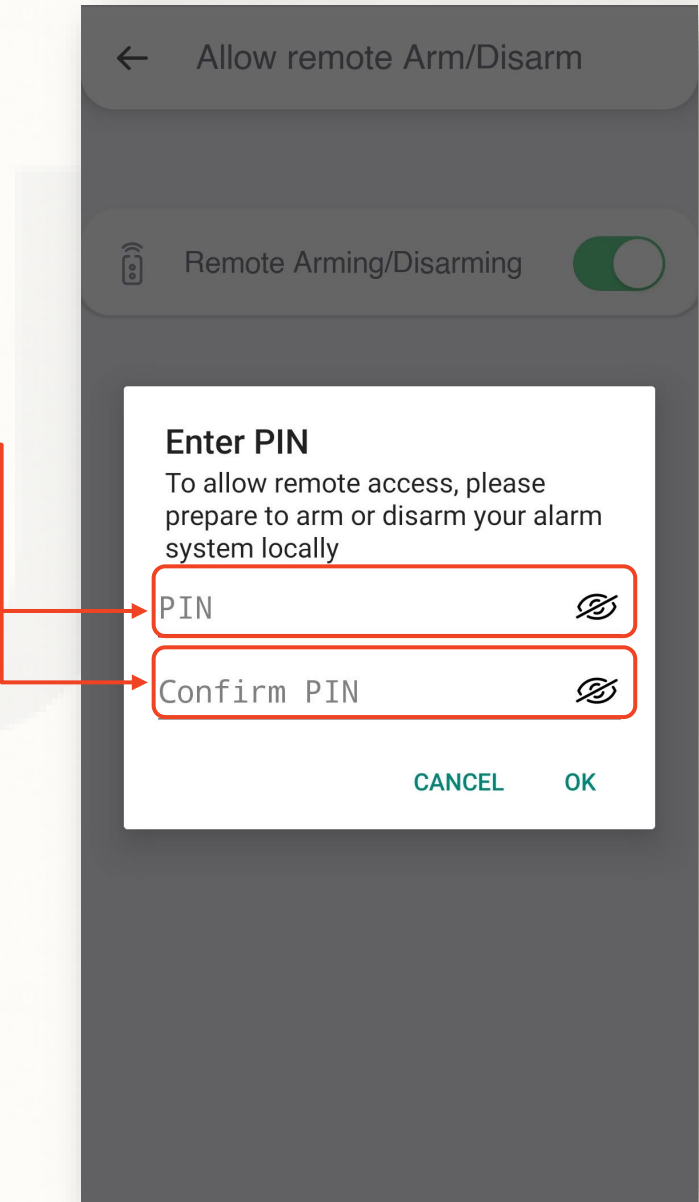

To complete the initial pairing procedure, you must arm and disarm the alarm panel locally (from the keypad) within 2 minutes.

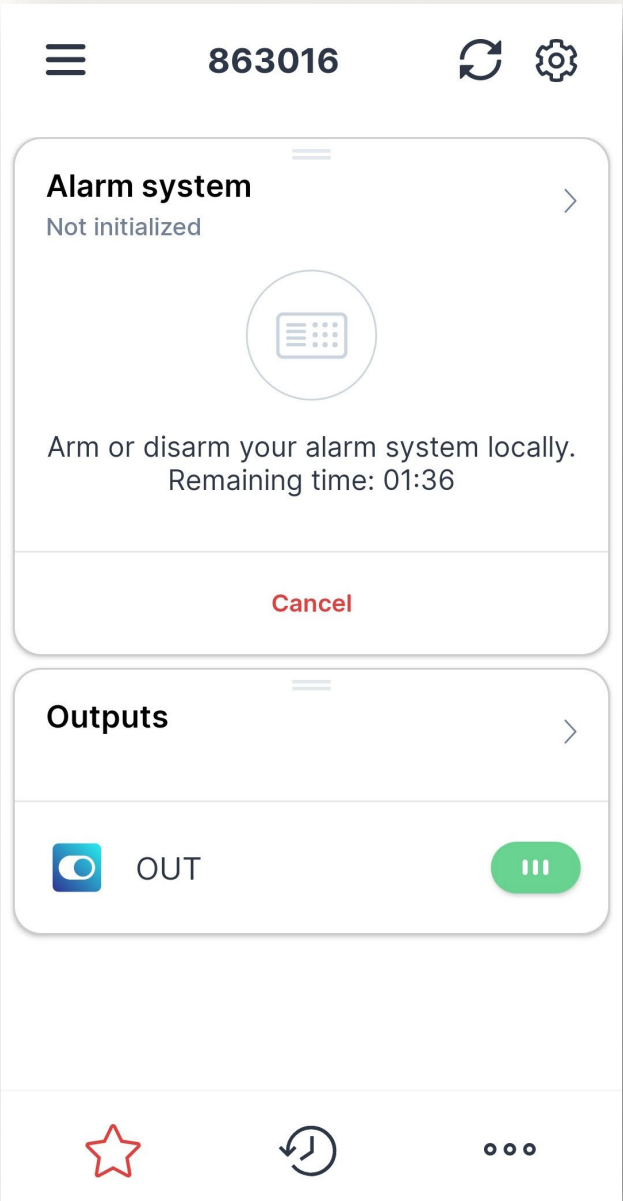
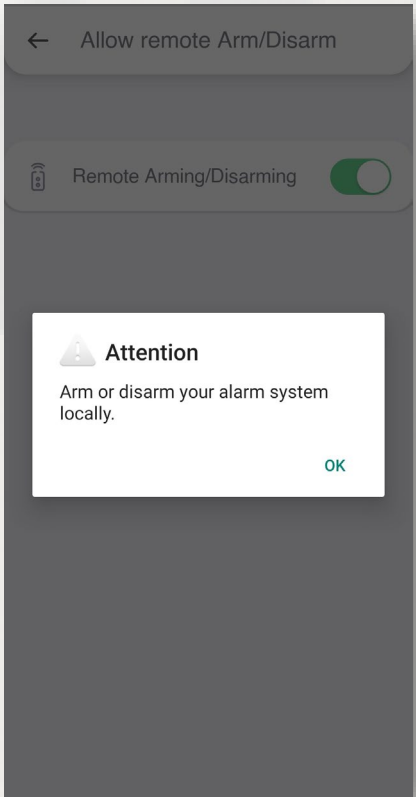

REMOTE ARMING/DISARMING (PIN CHANGE)

To enable this functionality, additional wiring and configuration of the alarm panel must be completed by the installer.

In case you want to change your PIN, you can change it by selecting "Change the remote PIN".

← Allow remote Arm/Disarm

Remote Arming/Disarming ☒

Sync with Panel >

Change remote PIN >

Enter the old PIN, followed by the new one twice and press "Save" to confirm.

← Change remote PIN

Old PIN

New PIN

Confirm PIN

Save

REMOTE ARMING/DISARMING (PARTITIONS)

To enable this functionality, additional wiring and configuration of the alarm panel must be completed by the installer.

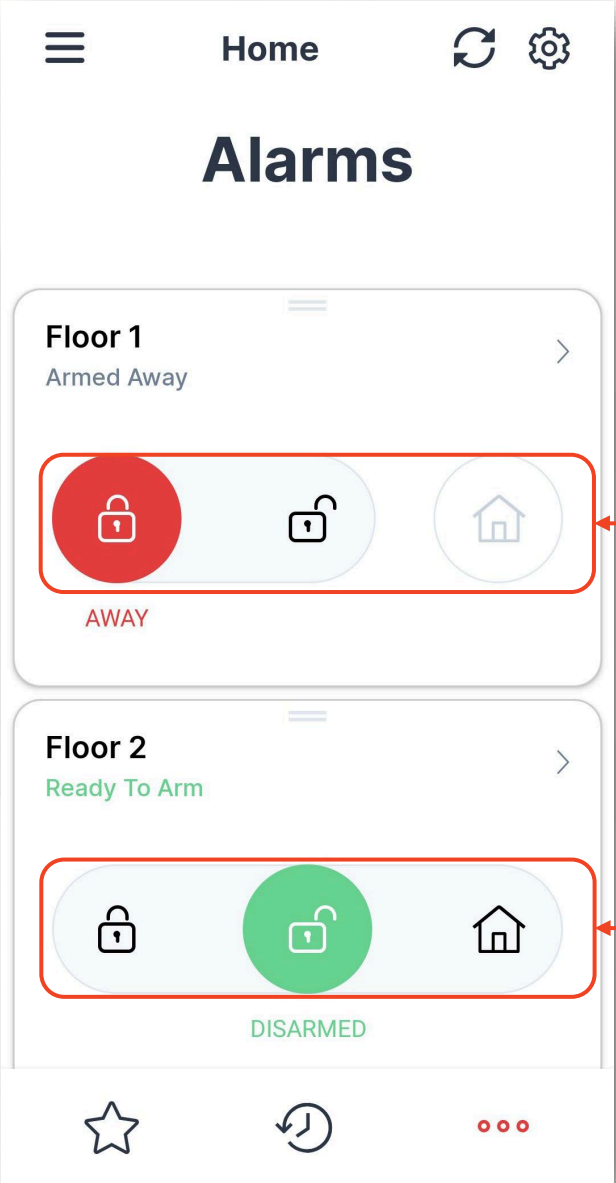

Use the slider to quickly "Stay", "Away" or "Disarm" desired partition.

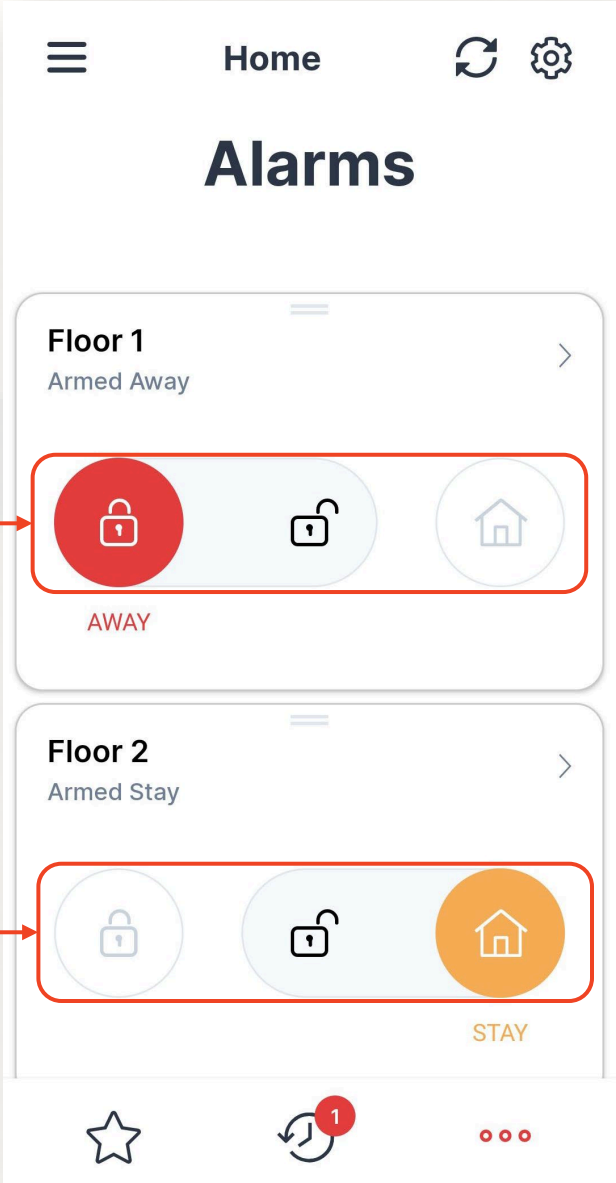

REMOTE ARMING/DISARMING (ZONES)

To enable this functionality, additional wiring and configuration of the alarm panel must be completed by the installer.

Use the arrow button to see the zones status and bypass a specific zone.

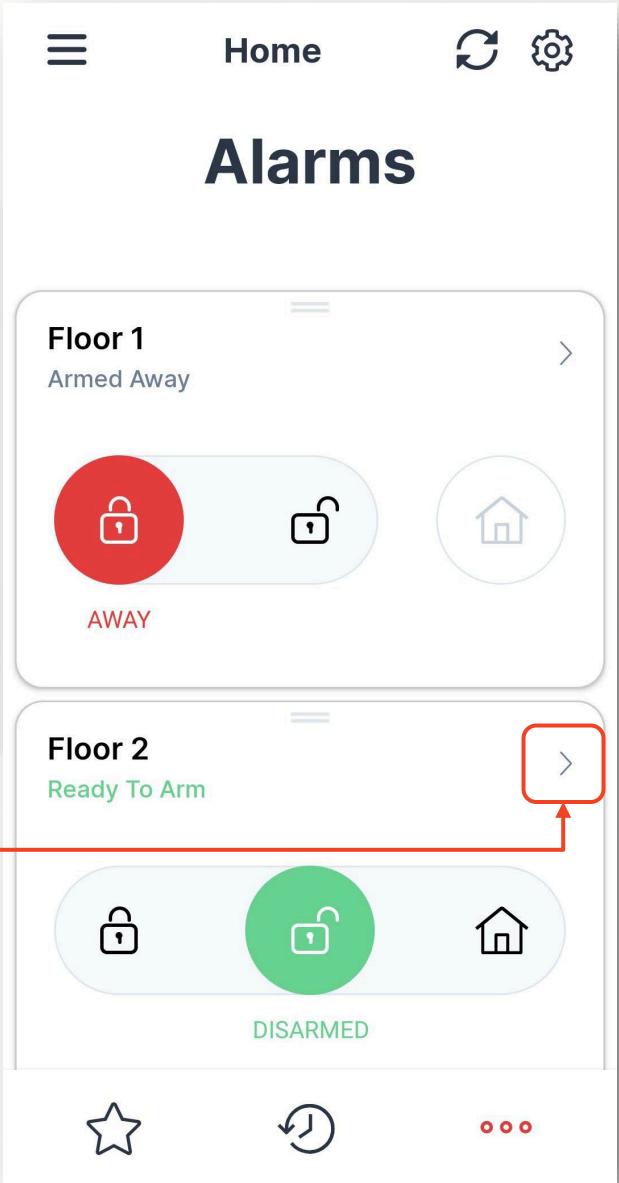

Slide the button to bypass/ unbypass the zone.

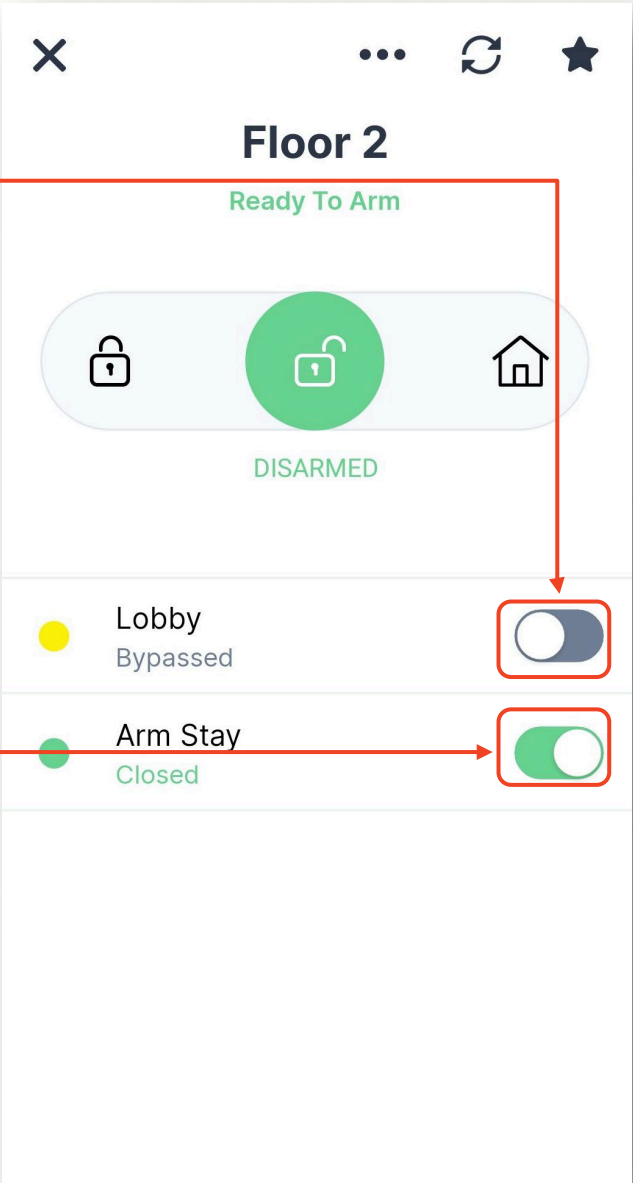

USERS

Go to “Users” menu if you want to add, remove, or edit the users.

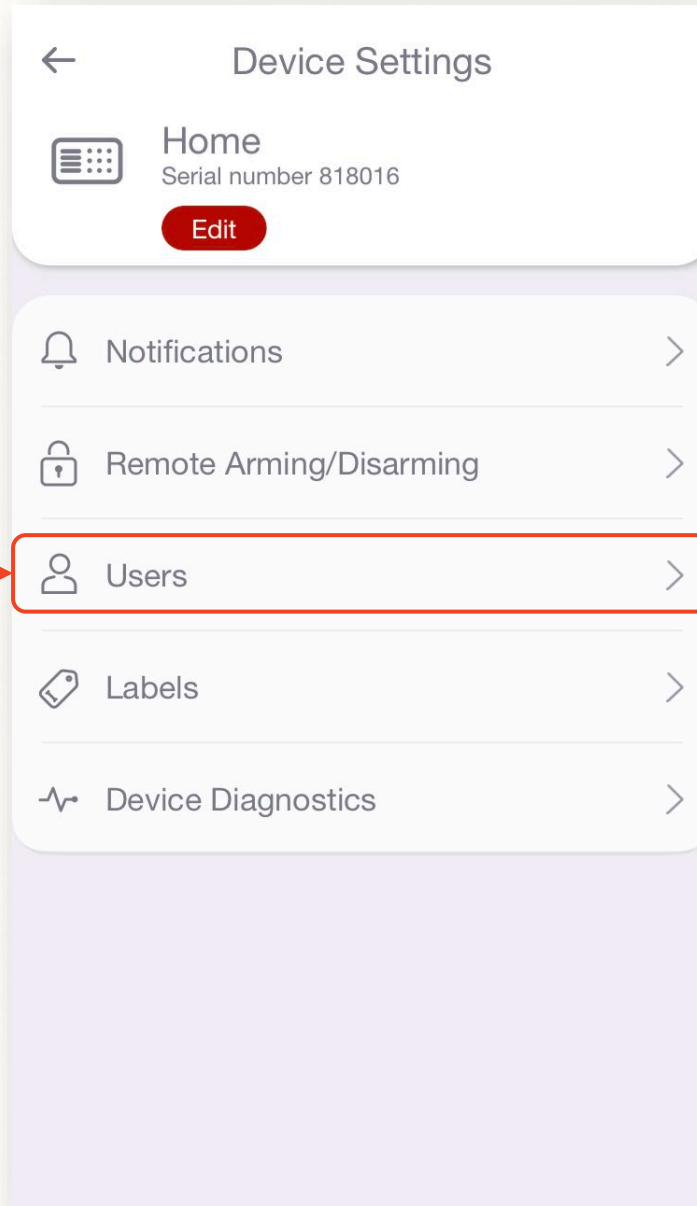

Select “Add new user” if you want to add additional user account to this device (e.g., spouse, kids, relatives).

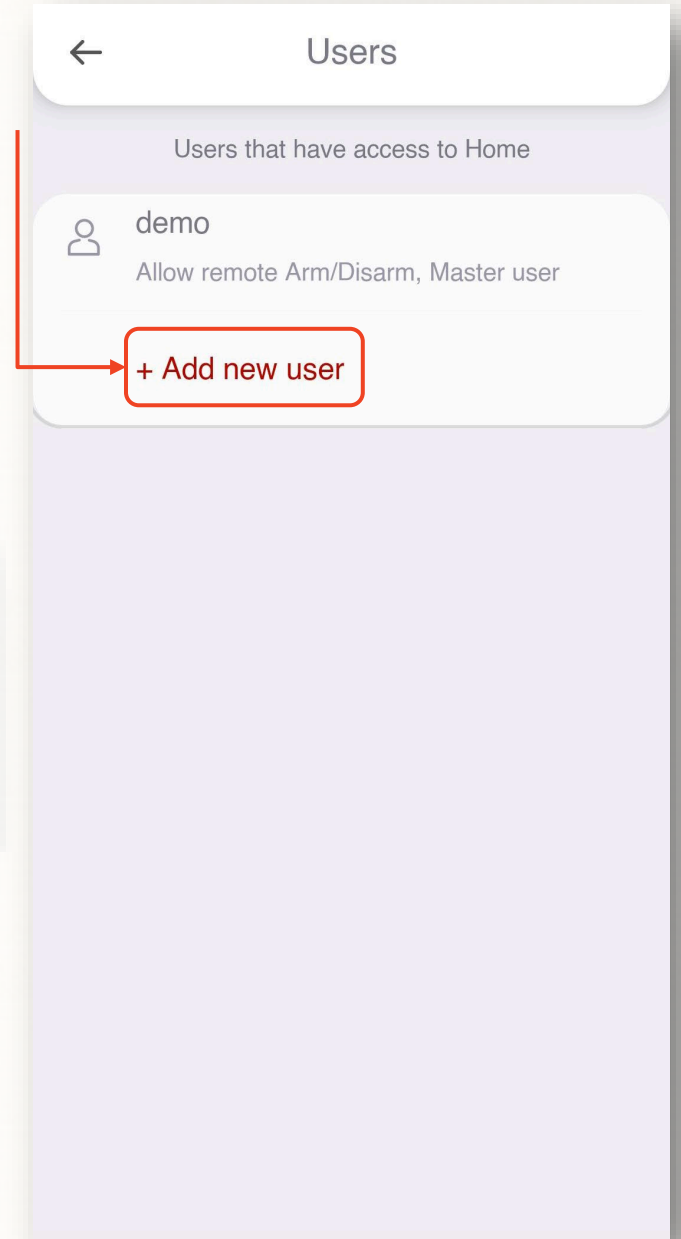

USERS

Populate the required information in the following fields.

Only “Master user” accounts can add new users, additional devices and label partitions, zones and users.

**For security reasons, we recommend that you create only one master user.*

The screenshot shows a mobile app interface for adding a new user. The form has a title bar with a back arrow and the text 'Add new user'. Below the title bar are several input fields: 'Full name', 'Login name', 'Password' (with an eye icon), 'Confirm password' (with an eye icon), 'Email address' (with a note: '* This email will only be used for password recovery.'), 'Allow remote Arm/Disarm' (with a checked checkbox), and 'Master user' (with a radio button). A red box highlights each of these fields. A red arrow points from the text 'Populate the required information in the following fields.' to the first four fields. Another red arrow points from the text 'To allow the remote-control permissions select “Allow remote Arm/Disarm” option.' to the 'Allow remote Arm/Disarm' checkbox. At the bottom of the form is a red 'Save' button.

To allow the remote-control permissions select “Allow remote Arm/Disarm” option.

LABELS

Navigate to “Labels” menu if you want to name your partitions, zones and users.*

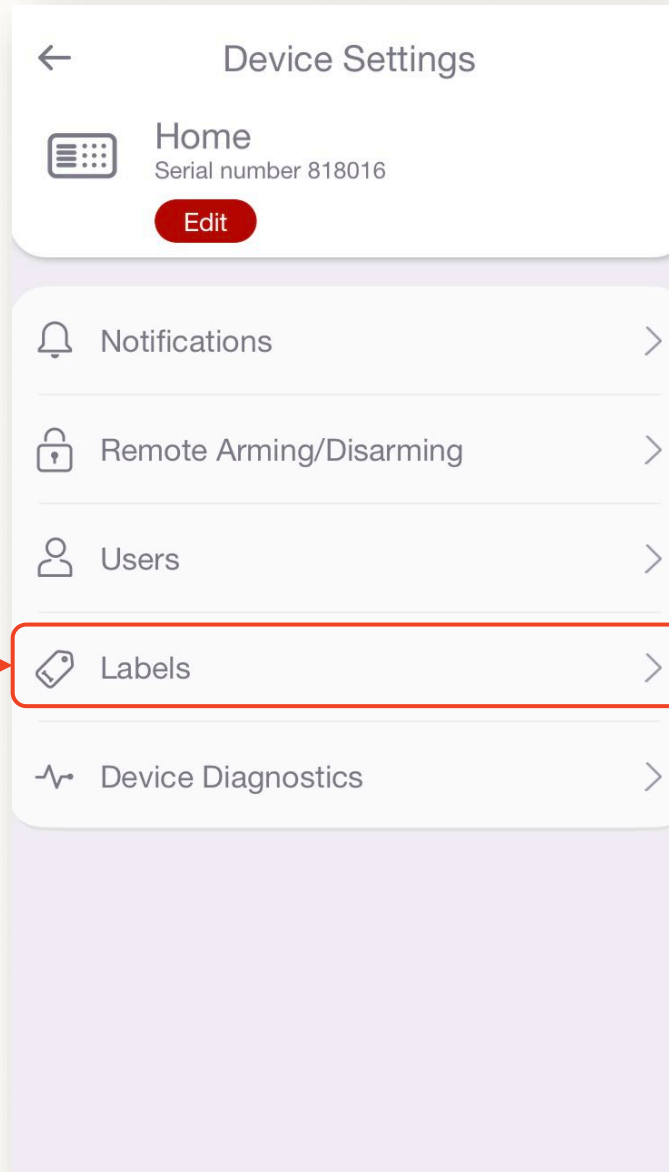

To label a partition, select “Add Label”.

To label a zone or user use the respective tabs.

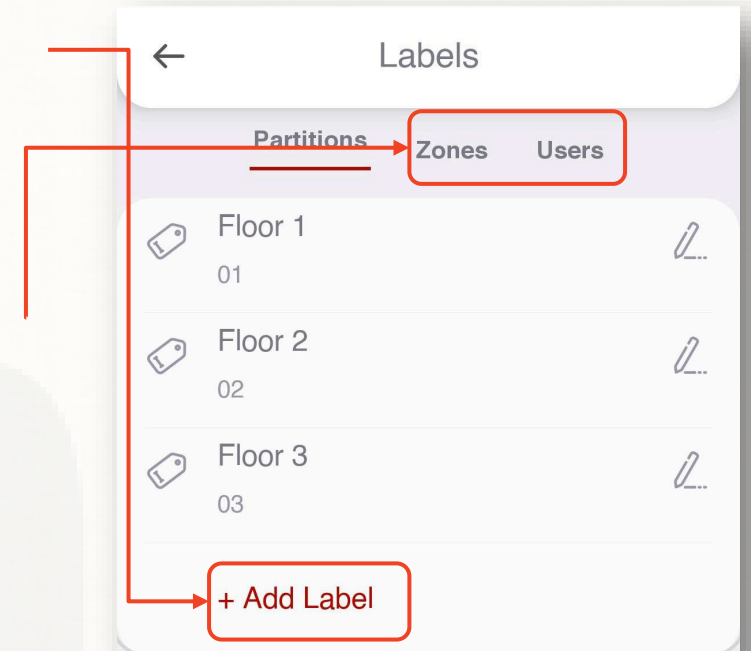

**To label partitions, zones and users you need to have a “Master User” account*

LABELS

Select the “Edit” button to edit existing label.

Labels

Partitions

Zones

Users

Floor 1

01

Floor 2

02

Floor 3

03

+ Add Label

Fill in the fields and press “Save” to save the changes.

Edit partition

Code

01

Label

Area 1

Save

You can delete permanently this label from here

Delete

LABELS (SHORTCUT)

Select the arrow button to edit a specific partition.

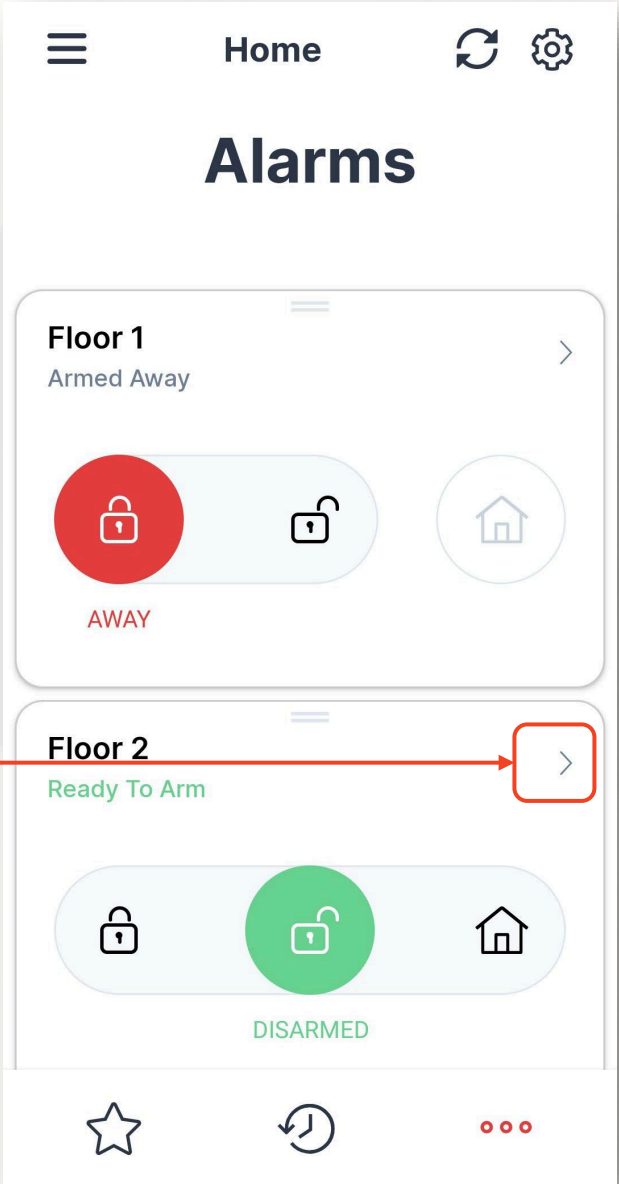

Select the "Edit" button to edit the labels of the partition.

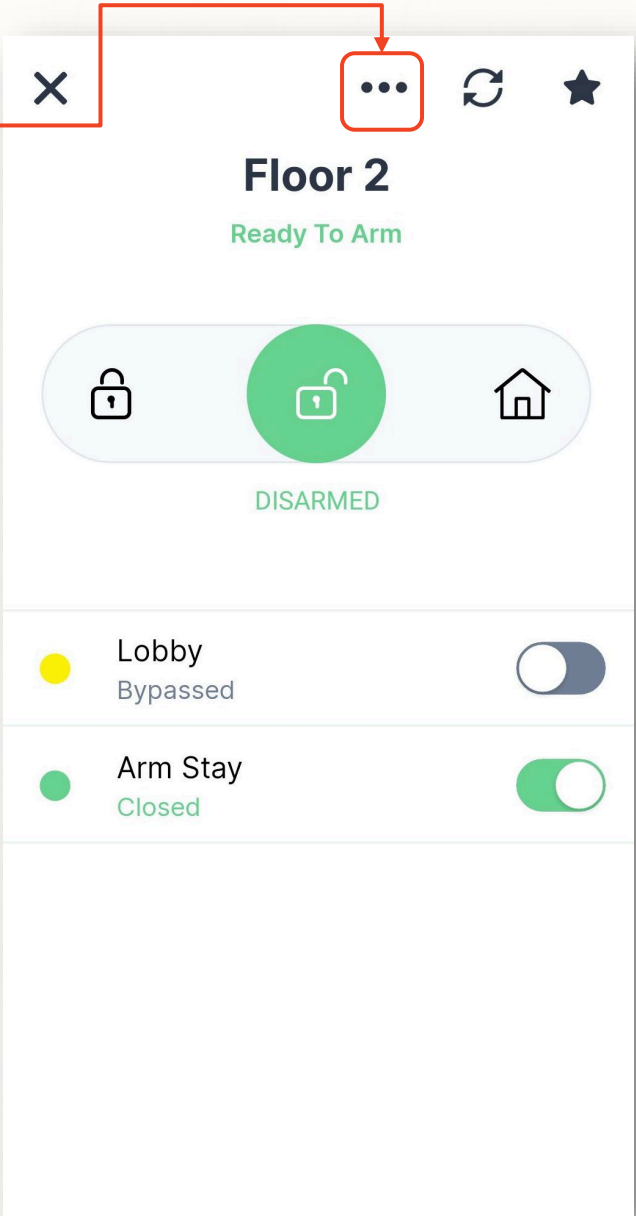

LABELS (SHORTCUT)

Press "Edit labels" to confirm you want to edit them.

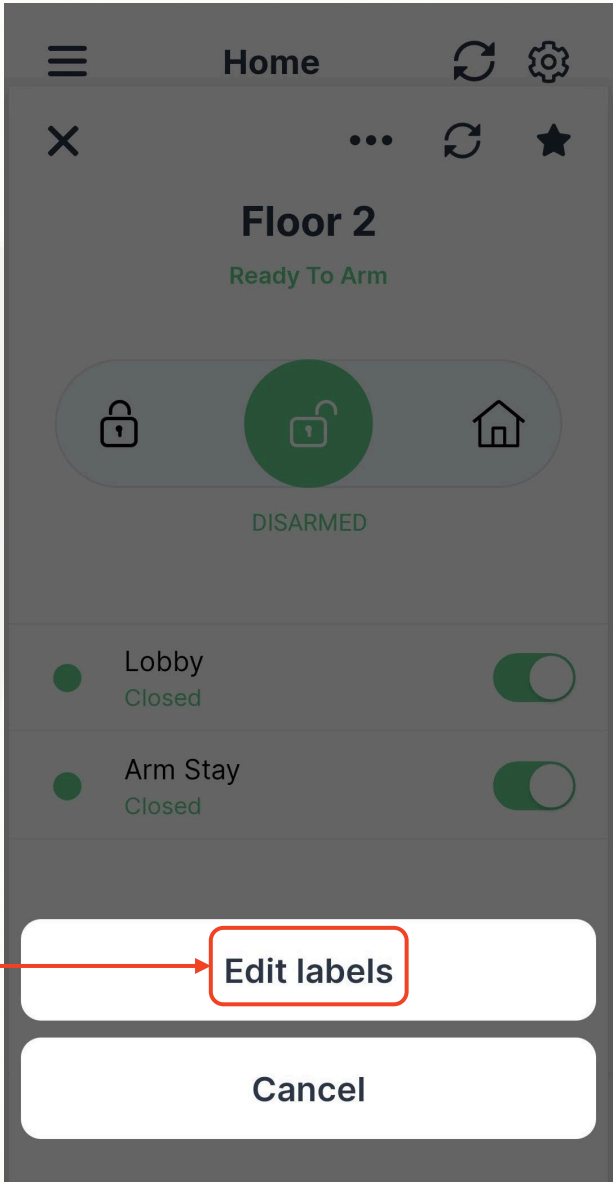

Type the changes and press "Done" to save them.

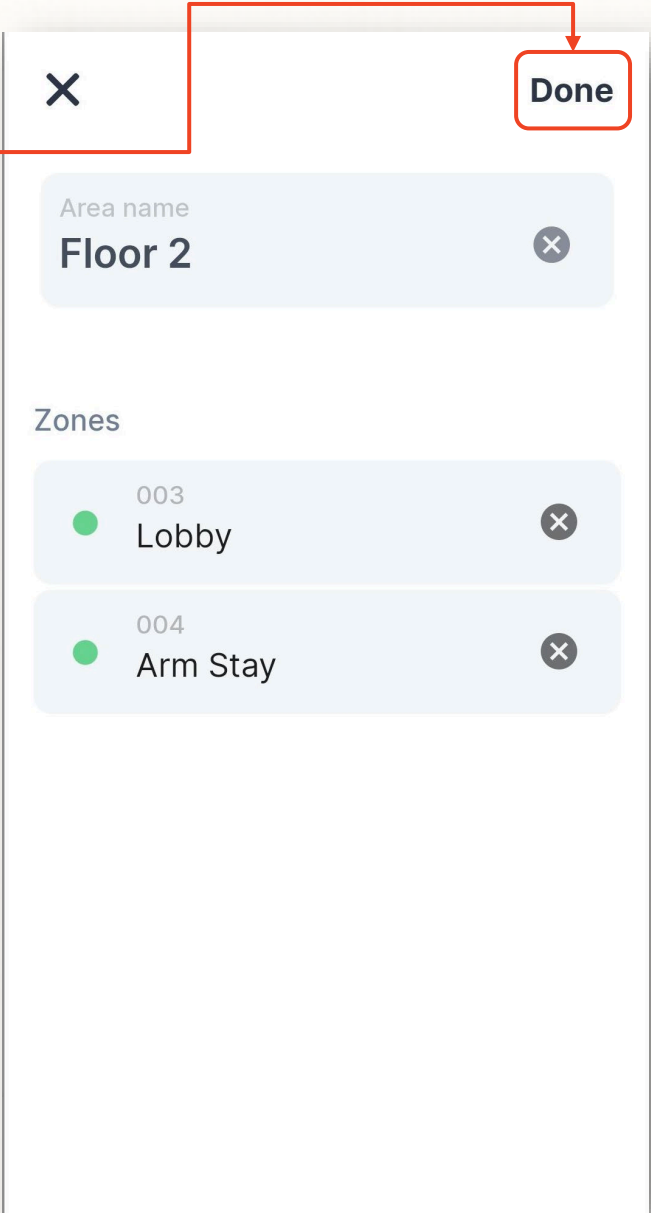

ADDING MORE DEVICES TO YOUR ACCOUNT

Go to “Add new device” if you want to manage additional devices from the same account.

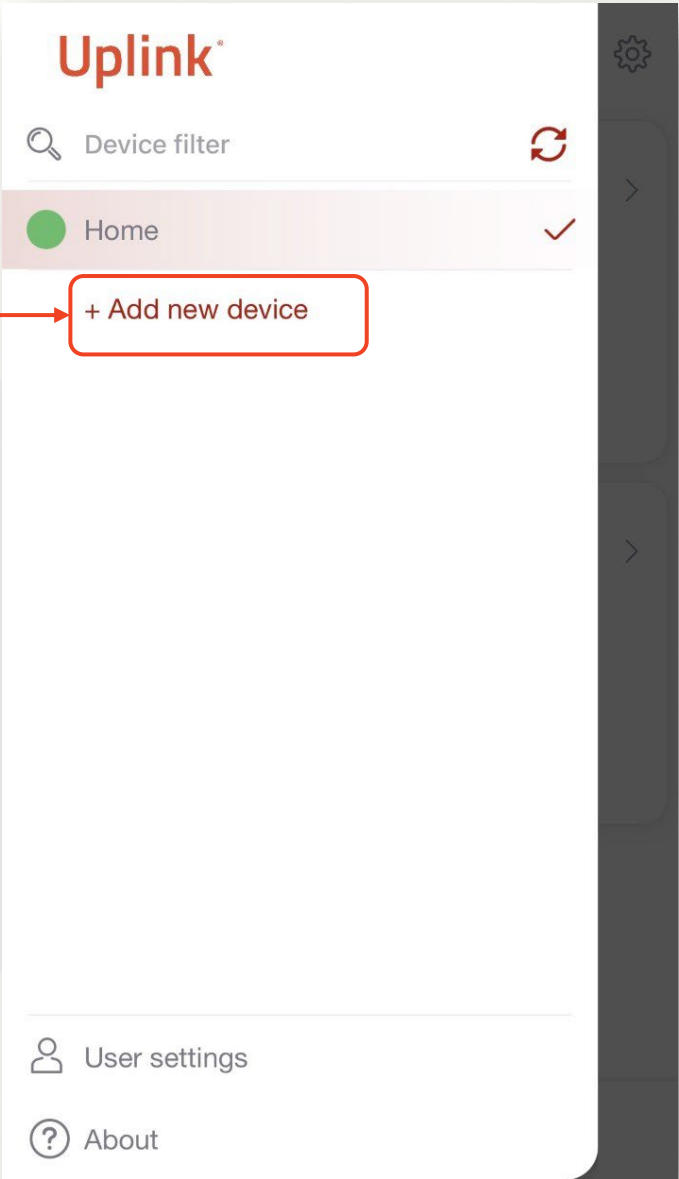
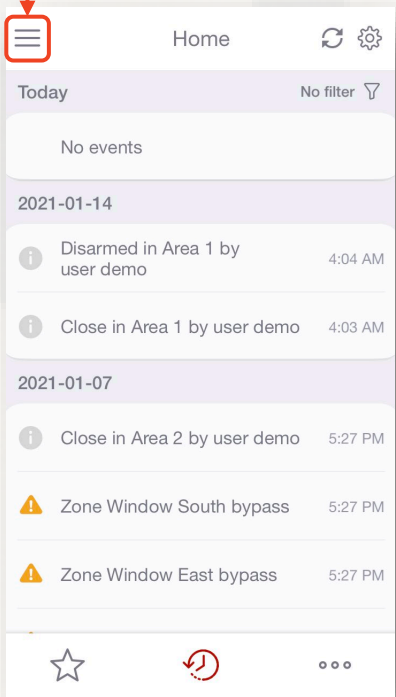

For new devices:
Enter the serial number of the device that you want to add to this account and the login credentials that comes on the device’s manual.

For devices that have already been in use:
You will have to provide the current username and password.

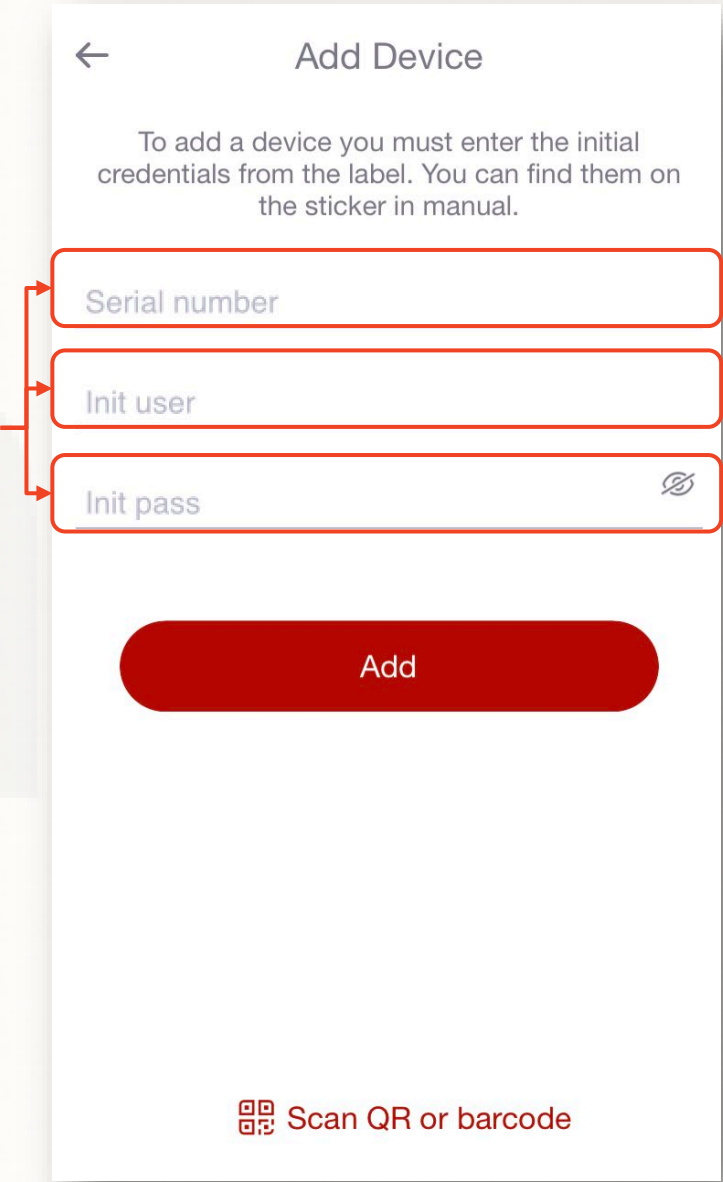

HISTORY OF EVENTS

Select "Events" from the main screen to see a list of the events back in time.

The history of events is kept for 12 months.

